

The Courses Down Brandywine Creek, from the Poplar to the Run.

- S. 60. W. 42.
- S. 8. W. 60.
- S. 15. W. 20.
- S. 26. W. 42.
- S. 34. W. 42.
- S. 47. W. 36.
- S. 20. W. 18.
- S. 6. E. 23.
- S. 30. E. 30.
- S. 56. E. 26.
- N. 69. E. 47.
- N. 30. E. 64.
- N. 42. E. 43.
- N. 56. E. 18.

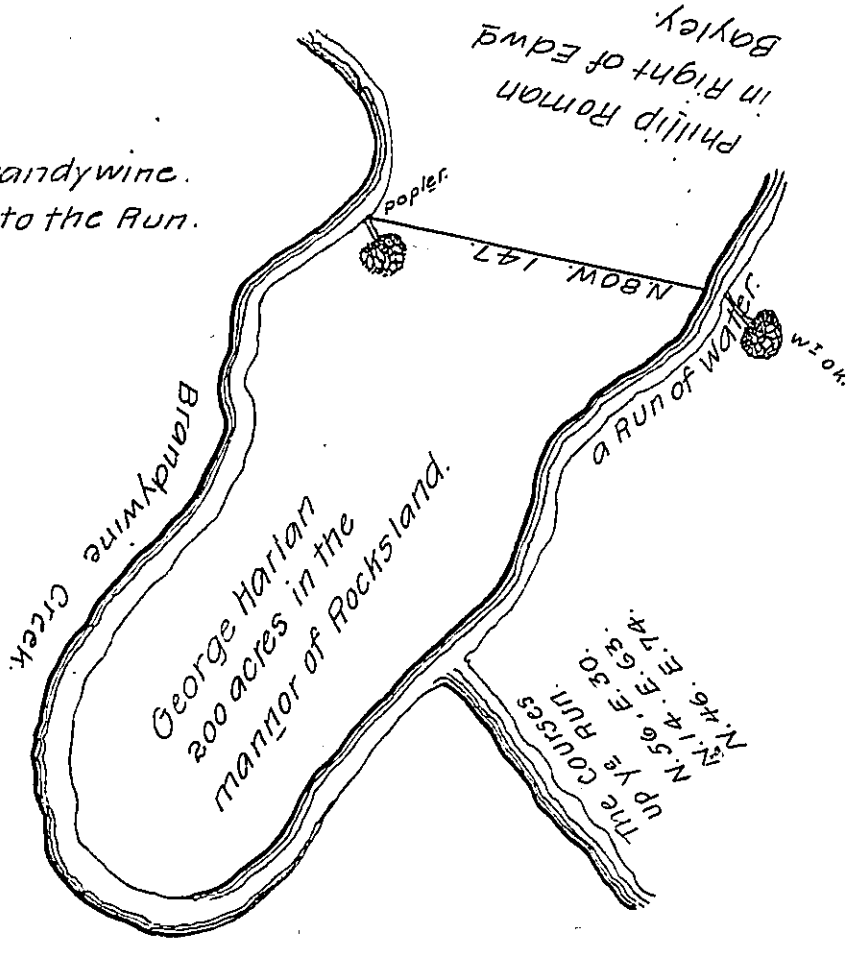

This is a true Draught of 200 acres of Land situate on the East side of Brandywine Creek in the County of Chester surveyed the 6th of ye second month 1702 to George Harlan by Virtue of a Warrant from the Commissioners, Dated 16th of ye 12th month 1701 to me Directed

P^r Isaac Taylor

IN TESTIMONY that the above is a copy of the original remaining on file in the Department of Internal Affairs of Pennsylvania, made conformably to an Act of Assembly approved the 16th day of February, 1833, I have hereunto set my Hand and caused the Seal of said Department to be affixed at Harrisburg, this eighteenth day of November, 1907.

Henry Howck
Secretary of Internal Affairs.